

# PINpad Wiegand Reader

The PINpad Wiegand Reader is a Wiegand reader and touchpad keypad combined in the same rugged housing. It is fully sealed against the environment and has a wide operating temperature range, making it ideal for outdoor use even under the most extreme conditions. The PINpad Wiegand reader mounts directly to a single gang box for easy installation. Its attractive appearance makes it a welcome addition in any location indoors or out.

The unique design of the PINpad Wiegand reader transmits both the card and the keypad data over the same Wiegand lines. This feature eliminates the need to pull separate wiring for each device.

The PINpad Wiegand reader is ideal for access control, time and attendance or other applications where Wiegand card data and/or Keypad data is required. Most access controllers can use either the card data or the keypad data for access during busy hours, and require the higher security level of the combined data during off hours.



## Specifications

### For use with code strip layout options:

- A long edge/right side
- A1 long edge/left side
- D short edge

### Input power:

5-12 VDC

### Current:

40mA typical

### Dimensions:

5.64" x 4.27" x 2.25"  
(14.3 x 10.9 x 5.7 cm)

### Slot width:

0.062" to 0.069"  
(1.6 mm to 1.75 mm)

### Material:

Long-wearing polymeric plastic

### Weight:

1 lb. 1.6 oz. (499 gm)

### Operating temperature:

-40° F to 160° F (-40° C to 70° C)

### Operating humidity:

10 to 95%

### Data output:

Wiegand formatted

### Keypad type:

Touchpad

### Certifications:

CE mark approved

### Cable distance:

Maximum cable distance is 100 feet (30.5 m) using six conductor, shielded 18 AWG cable. For distances greater than 100 feet the unit should be powered locally and a Line Extender used to transmit the data up to 5,000 feet (1524 m).

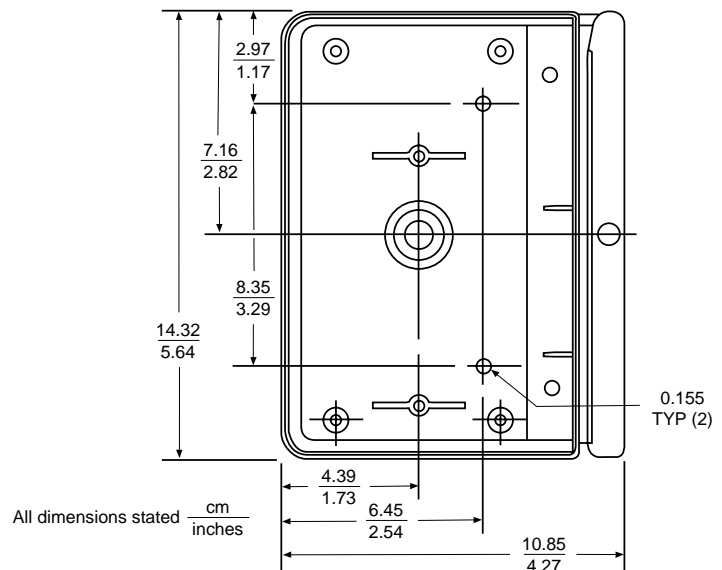

## Features

**Mounting:** The PINpad reader mounting holes fit a standard U.S.A. single-gang box (vertically mounted).

**Visual indication:** When a Wiegand card is swiped through the reader, the red LED flashes to green to indicate a proper read. Rejected cards are indicated with an amber color.

**Indoor / outdoor design:** The PINpad Wiegand reader is sealed in a rugged, potted, weatherized polymeric enclosure to withstand harsh environments and provide a high degree of vandal resistance.

**Warranty:** PINpad Wiegand readers are warranted against defects in materials and workmanship for life from date of shipment. (See complete warranty policy for details.)

## Part Number

Base Part No.: 310

Description: Black, Bi-color LED

Options: • Keypad Output (26-bit or 8-bit)

(Please see "How to Order" guide for a description of the options and associated part numbers.)

Specifications subject to change without notice.

LITPINPDS 8/97

Printed in the U.S.A.

© HID Corporation, 1997



333 State Street, North Haven, Connecticut 06473 U.S.A.  
Tel: (203) 287-9000 (800) 243-2563 Fax: (203) 407-5967  
Internet Address: <http://www.prox.com>