

Multiple Doorphone

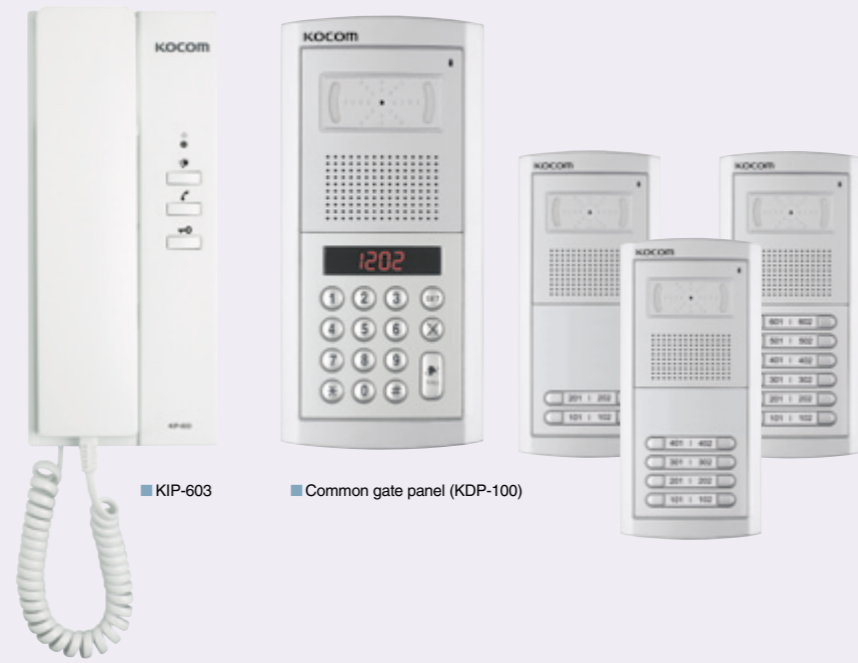

■ KIP-603 ■ Common gate panel (KDP-100)

[Multiple doorphone Configuration]

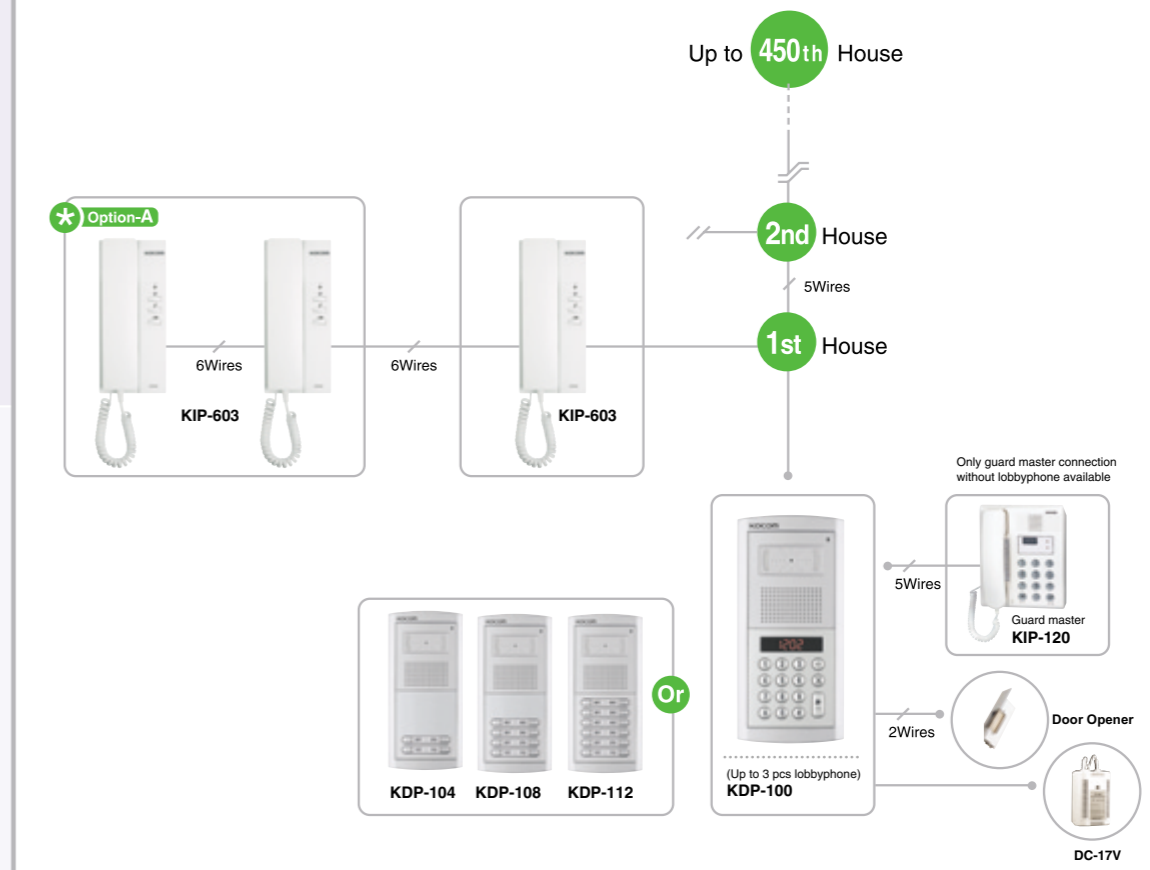

[KIP-603]

- For multi apartment, condominium & villa system, upto 450 houses are available
- Up to 3 indoor extension in a house
- Internal call & conversation function between extended indoor units in a house
- Audio conversation with visitor
- Door open (common gate) function
- Call & conversation function with guard master

[KDP-100 / KDP-104, KDP-108, KDP-112]

- Upto 4 houses (KDP-104), upto 8 houses (KDP-108), upto 12 houses (KDP-112)
- Upto 450 houses connection (KDP-100)
- Communication with guard master (KDP-100)
- Door open function by access code (KDP-100)
- Firm metal body case with new modern design
- Upto 3pcs of common gate panels connection in a building

Specifications

Model no.	KIP-603	KIP-120	KDP-100 / 104 / 108 / 112
Power	DC 17V (±1V) powered from common power supply		
Power consumption	Max. 5W, Stand by 2W		
Assurance temperature	0°C ~ +50°C		-20°C ~ +50°C
Wiring	5wires (common wiring)		
Max. wiring distance	∅0.8 single cable : 300m, 5C-2V coaxial cable : 500m		
Mount type	Surface mount		Flush mount
Dimension (mm)	92(W) x 210(H) x 57(D)	165(W) x 220(H) x 80(D)	120(W) x 255(H) x 39(D)
Weight (Approx. kg)	0.5kgs	1.0kgs	1.0kgs

• The product may include option or additional functions.

KLP Series Accessories

