

Warranty



To receive after-Sale service, have the following ready when you contact our branches

1. Name of the product
2. Model number of the product
3. The area of problem
4. Phone number and address at which you can be contacted.

Warranty Card

PRODUCT	
MODEL	
DATE PURCHASED	
WARRANTY PERIOD	
AGENCY ADDRESS	

● KOCOM Warranties the original purchaser of this product as follows.

- 1) This product is produced under strict quality control and inspection procedures.
- 2) If this product breaks down during proper use as a result of product defect, KOCOM will repair it within one year from date of purchase free of charge.
- 3) The following cases will be subject to charge, even during warranty period:
 - a. Breakdown during transport, or through careless treatment, by consumer.
 - b. Breakdown cause by unauthorized repair, or system modification.
 - c. Breakdown caused by natural disaster or power disorder.

This manual is based on the date as shown in the right and specifications are subject to change without notice for quality improvement.

KIV-201C 04.07

KOCOM

HANDS-FREE VIDEODOORPHONE

KIV-201C Operating Installation Manual

Clear & Bright Picture at Low Light

- 4" TFT LCD
- 4 Wired
- Easy Installation
- Slim Size Camera
- Wide view angle (120°)
- Hands-free System

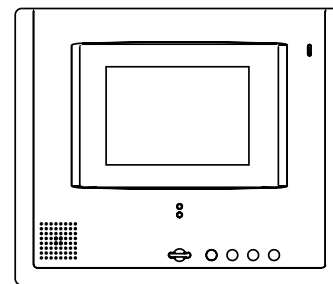

KIV-201C

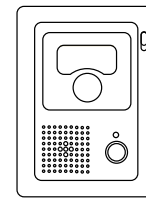

KC-C60

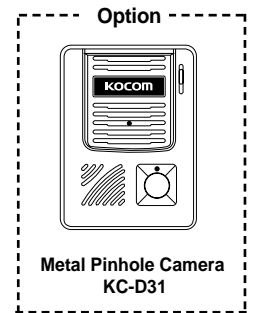

Metal Pinhole Camera KC-D31



KOCOM CO.,LTD.

www.kocom.com

e-mail:export@kocom.co.kr

Precautions for Operation

<p>Keep away from humidifier and stove. High temperature and humidity can cause breakdown.</p>	<p>Do not drop monitor or door camera, and avoid strong impact.</p>	<p>Keep away from devices generating strong magnetic field (TV, Speaker, etc.) (Picture can be disturbed or blurred and breakdown can result)</p>
<p>When cleaning, never use wet hands, volatile benzene or paint thinner.</p>	<p>Keep picture clear by cleaning camera window frequently with soft cloths.</p>	<p>As this device consists of electronic precision components, and high voltage is generated internally, do not attempt to disassemble.</p>

Installation Precautions

- Monitor and camera must be installed away from direct light and counter light.
- Camera must be installed at a place free from rain.
- Standard height of monitor must be 1,450mm~1,500mm from ground, centered around brown tube.
- Camera should be installed on the wall in which cement is completely dry.
- If installed during winter season at temperature below -5°, condensation might be generated inside monitor and camera due to temperature difference between indoors and outdoors. To prevent breakdown due to such condensation, connection should be made in 2 hours or more after installation.
- Do not install monitor and camera in locations subject to direct heating as harmful gases may subsequently be emitted in significant amounts.

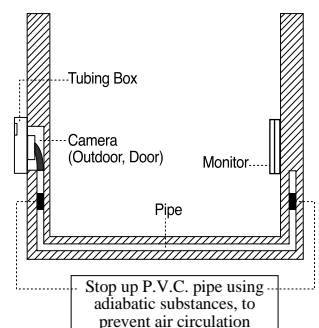

※ Stopping up pipe as above minimizes temperature difference between indoors and outdoors, and also eliminates moisture and condensation on door camera window.

Component

● Monitor & Camera

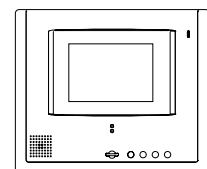

● Camera Accessories

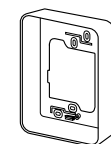

- Main body supporter



- Upward adjusting supporter for adjusting lens angle upward

● Monitor Accessories

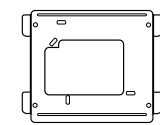

- Wall hanger panel

- Screws for fixing (4x25mm)

- Screw for fixing camera to panel (2.6x6mm)
- Screw for fixing camera main body supporter (4x25mm)

Specifications

MONITOR (KIV-201C)	Power source	SMPS Type AC 110V/220V	
	Power consumption	Max.19W, Stand by : 2W	
	Ambient temperature	0°C~+50°C	
	TFT LCD	4 inch Color TFT LCD	
	Communication system	Hands-free system	
	Call signal sound	Camera:Ding-dong, guardroom: Melody	
	Output Impedance	Picture : 75ohm, Voice : 600ohm	
Wiring	4 Wired in polarity / 2 Wired in non-polarity		
Max Wiring Distance	Camera:φ 0.65 Single Cable/50m Guardroom:IV 0.9mm		
CAMERA (KC-C60)	Power source	DC12V ± 1V(power from Monitor)	
	Ambient temperature	-10°C~50°C	
Metal Pinhole Camera (KC-D31)	Angle of picture	Diagonal 120°	Diagonal 90°
	Min. Illumination	0.1Lux (LED ON)	
Metal Pinhole Camera (KC-D31)	Lens	F:2.0, f=3.0mm	F:3.5, f=3.8mm
	Dimension	95(W)×127(H)×34(D)mm	95(W)×127(H)×33(D)mm

Name of each part

■ KIV-201C Monitor

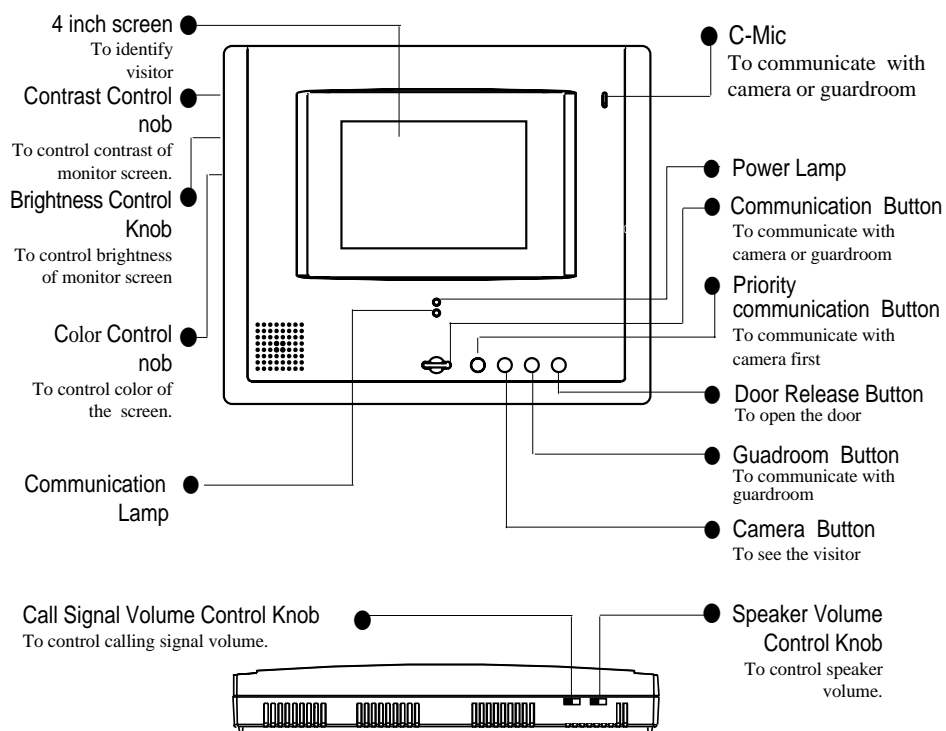

■ KC-C60 Camera & KC-D31 Metal Pinhole Camera

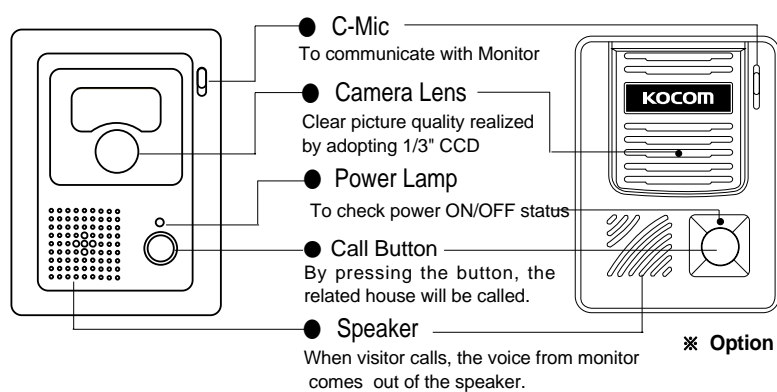

How to operate (Instruction for operating)

■ Call from visitor

1. When visitor presses call button of door camera, the ding-dong sound is made from monitor and visitor image appears in the screen of the monitor.
2. After checking the visitor through the screen, press communication button then you can communicate with visitor.
(The screen of the monitor is automatically off after 3 minutes.)
3. When the conversation is finished with visitor, press communication or camera button, then screen is off. And you can press door release button in order to open the door automatically.
4. If you want to check the outside, press camera button then the screen is on and you can check outside.
(But you cannot communicate with camera. If you want to communicate with camera, press communication button.)

※ Instruction for the priority communication button

(It is only available with the communication through camera)

The function of priority communication button is to send the voice from the monitor to camera in priority.

Ex) In case the voice from monitor to camera is not heard well and clearly due to the heavy noise outside, press this priority communication button, then the visitor can hear the voice from the monitor well and clearly.

Video Doorphone Wiring Diagram

■ Wiring Diagram

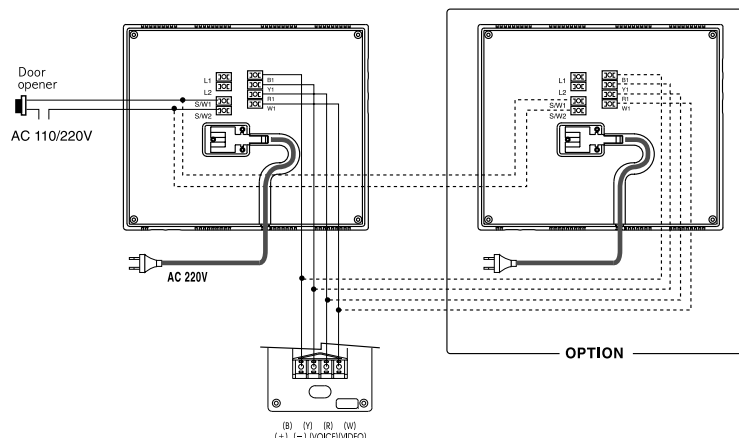

Caution for wiring

- Wiring between videophone and camera is 4 wire in polarity and use ϕ 0.65mm or more single cable
- Connecting wiring between monitor and door camera should not be installed near other electrical cable, nor be horizontal. (In such case, clear picture can not be expected due to interruption by electrical noise)

Monitor Installation

When system is attached to 1 rectangular switch box

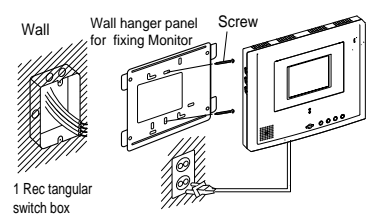

Basic Installation method of Monitor

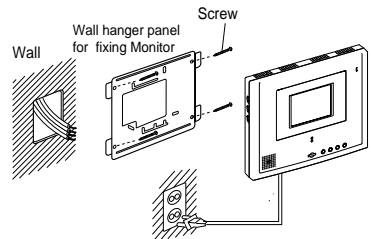

■ Standard height monitor

- Standard height of monitor is ranged 1,450 ~ 1,500 from bottom to the center of monitor screen.
- For installation, avoid the places where there is any excessive humidity, magnetic force, dangerous chemicals, direct ray of sun, and any places near a heater which can cause break down.

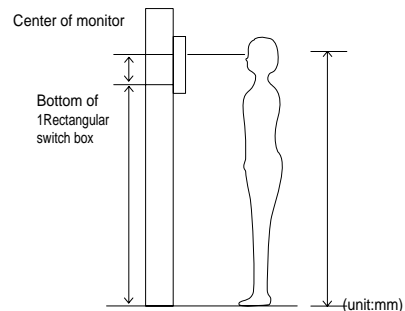

Door camera Installation

■ Surface-mounting Door Camera Installation

Straight Ahead Installation

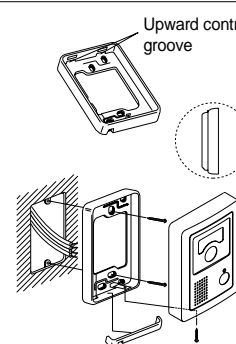

After attach the body supporter with 2 screws(4x10mm), put the Door Camera into the grooves of body supporter, and then fix it with a screw(2.6x6mm).

Looking "Upward" Installation

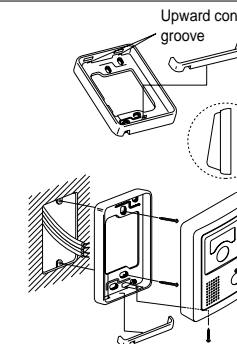

After attach the body supporter with 2 screws(4x10mm), insert the upward support into the upward groove of body supporter, and then fix it with a screw(2.6x6mm).

Looking "Downward" Installation

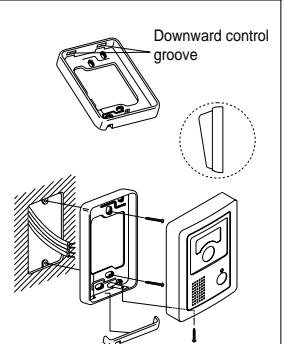

After attach the body supporter with 2 screws(4x10mm), insert the Door Camera into the downward control groove, and then fix it with a screw(2.6x6mm).

■ DOOR CAMERA INSTALLATION

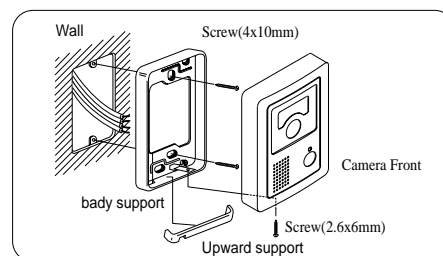

■ Standard Height of Door Camera

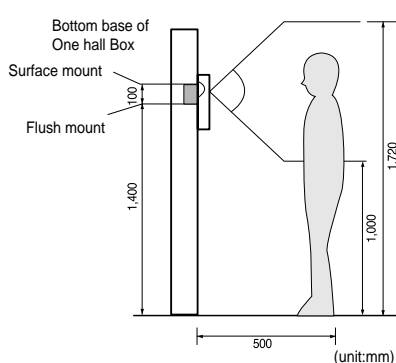

- Standard height of the door camera is 1,400mm ~ 1,450mm from the bottom of one camera to the floor.
- In case that the height of Door camera exceeds the range of min. 1,250mm ~ 1,550mm, it is impossible to control the screen picture with only the lens angle, and therefore, be careful of the height of camera installation.