

# FOTO30SDE

The photocell FOTO30SDE has been designed and created for use on power operated doors (gates, doors,..). It has autotest function, usable with control units able to manage it (e.g. EURO1MF or EURO2MF). The autotest function is carried out as follows : before any manoeuvre the station inhibits the transmitter by sending a voltage between +5 and + 24 V dc on terminal N° 3. The absence of the infrared beam thus brought about generates, with a 20 ms. delay, opening of the receiver's N.C. contact. The station checks that the described procedure is properly carried out before each manoeuvre. It complies with european directive 98/336/EEC (EMC).

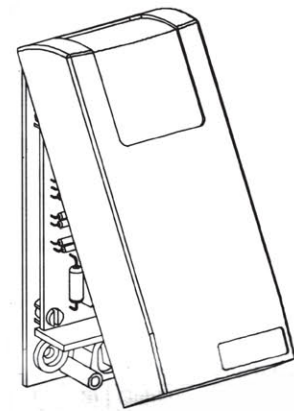
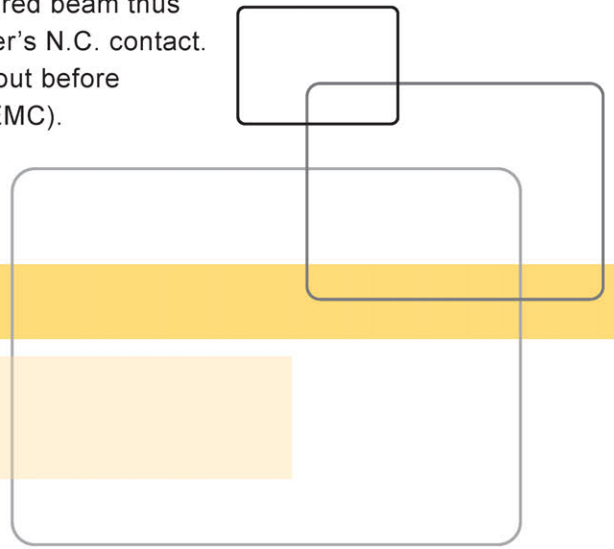

FIG. 1

## MAIN TECHNICAL FEATURES:

MODEL	FOTO30SDE
Power Supply (TX - RX)	12 ÷ 24 V ac/dc
Rest/Work consumption	50mA (TX + RX)
Working frequency	850Hz +/- 10%
Modulation frequency	1000Hz
Degree of insulation	IP 45
Infrared wavelenght	850nm
Relay contact capacity	0,5 A @ 24V ac/dc
Infrared beam range	30m nominal (8m in external use)
Working temperature	-20 + 70°C
Intervention time	< 20ms
Size	110 x 50 x 25mm
Weight	200g

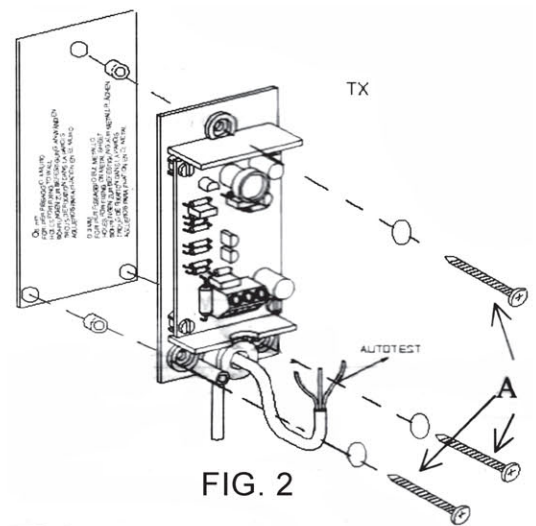

FIG. 2