

# EVO2000/2000T

## OILBATH GEARMOTORS FOR SLIDING GATES



ENCODER

only EVO2000



SLOWING



OIL BATH



INDUSTRIAL

available on all 3 models

Electromechanical gearmotor in oilbath ideal for industrial sliding gates up to 2000 Kg. Complete with magnetic limits and available in two versions: 230 V and 400 V.

**Safe and precise** thanks to the encoder and the slowing down in opening and closing (230 V), and motor with electromagnetic brake (400 V).

**Versatile** fixing plate with adjustable height and depth.

**Reliable** with a sturdy aluminum base treated against oxidation, all gears in oilbath. **Constant performance** over time and in any condition thanks to reduced wear&tear and the possibility to maintain the oil at the ideal temperature using HOT (optional). Manual release with coded lock.

### EVO2000

**230 V** irreversible electromechanical gearmotor. Electronic brake and built in control unit.

### EVO2000T

**400 V** irreversible electromechanical gearmotor. Dry clutch, electromagnetic brake. Without control unit.



release key

TECHNICAL SPECIFICATIONS	EVO2000	EVO2000T	TECHNICAL SPECIFICATIONS BUILT IN CONTROL UNIT	EVO2000	GENERAL DATA	EVO2000	EVO2000T
Motor power supply	230 V	400 V	Model	T101	Working temperature	-20+55 °C	-20+55 °C
Max. motor current	4,3 A	2,7 A	Power supply	230 V	Protection level	IP 44	IP 44
Motor power	1000 W	1800 W	Max. current	6,3 A	Weight	21 Kg	22 Kg
Max. torque	50 Nm	90 Nm	Electronic slow down	YES	Pallet	20 pcs	20 pcs
Thrust	1400 N	2500 N					
Max gate weight	2000 Kg	2000 Kg					
Actuator speed	10 m/min	10 m/min					
Work cycles	50%	intensive					
Capacitor	20 µF	-					
Encoder	YES	-					
Magnetic limit switch	YES	YES					
Thermal protection	160 °C	160 °C					
Electromagnetic brake	-	YES					
Oil lubricant	TS60	TS60					

# EVO2000/2000T

## INSTALLATION DIAGRAM

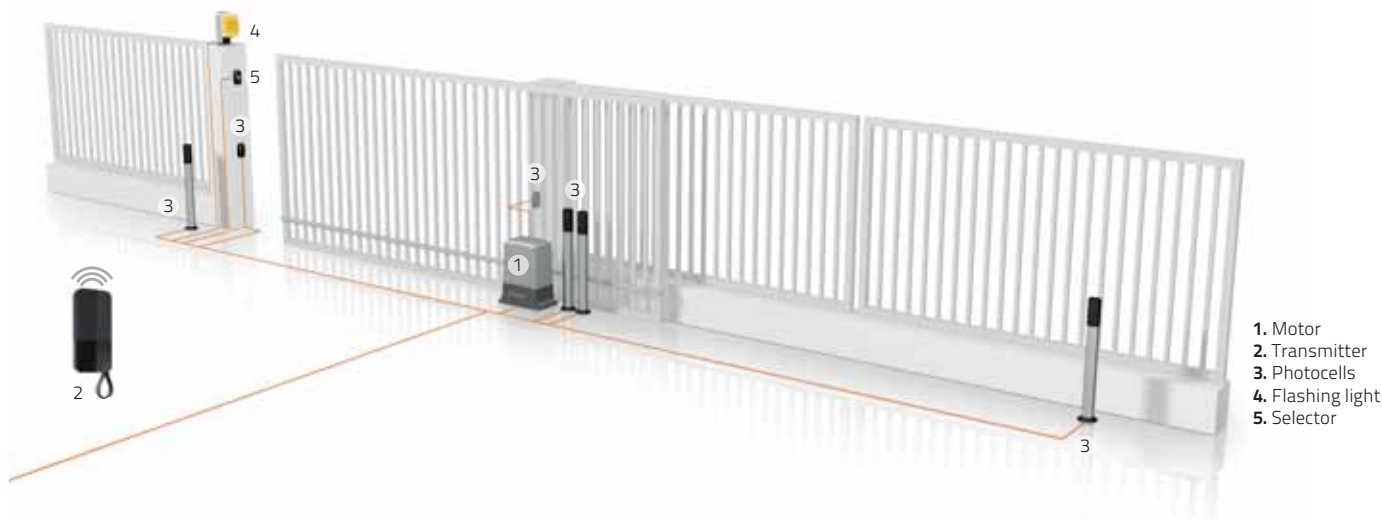

- 1. Motor
- 2. Transmitter
- 3. Photoceils
- 4. Flashing light
- 5. Selector

## DIMENSIONS

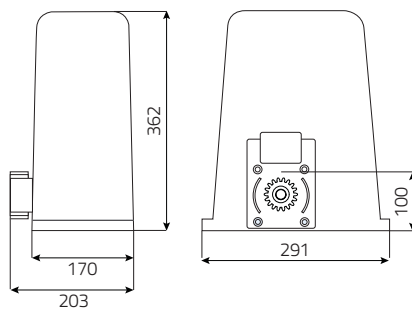

Dimensions in mm

## ACCESSORIES

### CREM12

Metal rack. M4 30x12 mm, complete with weldable spacers DSC, screws M8x25 TE and washers Ø 8. Pack of 4 pcs 1 m each.



### CREM22

Metal rack. M4 22x22 mm, weldable without spacers. Pack of 4 pcs 1 m each.



### DSC

Weldable sapcers for CREM12 and CREM8. Pack of 30 pcs.



### DAC

Screwable spacers for CREM12 and CREM8. Pack of 30 pcs.



### DAP

Screwable and adjustable spacers for CREM12 and CREM8. Pack of 3 pcs.



### T400

Control unit for 230V mono-phase or 400V tri-phase motors. Perfect for EVO 2000T.

#### SERIE OC2

2 channels plug in receiver.



### HOT

Electronic heating system with temperature sensor, for 230V motors.



### TS60

Oil for EVO2000 and EVO2000T. 1 liter.



### RVS

Mechanical brake for gates on sloping ground.

