

C · O · R · K · E · Y

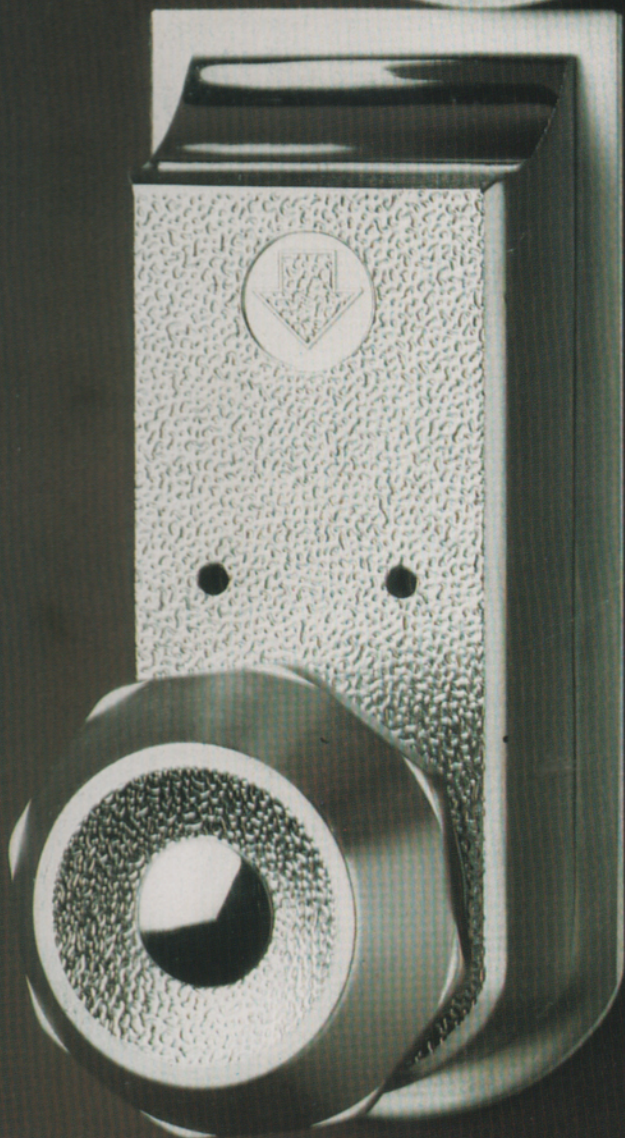

ACCESS CONTROL
AND SECURITY





ODES are changed by inserting a small code-changing tool into either of the small holes on the face of the lock. An encoding kit which permits users to encode or erase Corkeys is available. Once a coded key has been erased it can be put in stock and re-used at a later date. Should a key be lost or stolen, whether sub-master or servant, the lock can be programmed to accept a new key, making the lost key redundant.

MAGNETICALLY CO



2



3

SEC

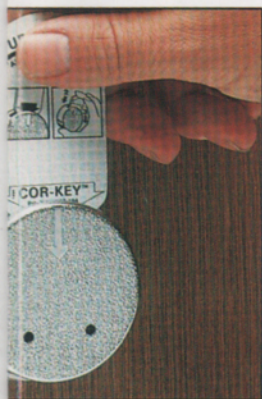

Corkey offers unrivalled opportunities for master keying and zoning. Particular advantages include construction keying and the facility to suite or re-suite when a user's requirements are known or have changed.

When any maintenance or similar work is required, Corkeys can quickly be encoded to give access through specific doors only, this enables security to be maintained and removes the need to issue sub-master keys.

DED CARD CONTROL



1. The Corkeys

Keys carry invisible magnetic code and are highly resistant to accidental demagnetising. Corkeys are infinitely recodable.

2. Encoding a Corkey

Corkey is placed in the jig, code-card locates over the jig and magnetic code is applied by the encoding gun.

3. Erasing a Corkey

This is only necessary if you are moving Corkeys between systems. Hold the Corkey against base of eraser to remove old code prior to re-use.

4. Encoding and Servicing Kit

The large encoding and servicing kit contains all tools, fixtures and instructions necessary for assembling, coding and decoding locks and keys. A smaller validating kit is used solely for re-coding keys.

5. Changing Codes

With master key and change tool, lost or stolen keys are invalidated within seconds and lock is ready to accept recoded key. This facility can also be used to vary access to certain doors for specified times or occasions.

6, 7, 8. Fitting a Corkey

The illustrations show how Corkey can easily be fitted to a cylinder rim night latch. The existing cylinder is simply removed and replaced by Corkey, often without any adjustment to the fixing plate.

9. Corkey 708K Double Sided Unit on Long Backplate

Outer plate has four bolt-through fixings. Inner plate secured by woodscrews. Security screws can be supplied to order.

10. Corkey 400AV and 403

A new, slimmer version of the original 400 series unit, this is designed for use with Assa mortice locks (400AV) or rim night latches (403).

We recommend CKM1 metal keys for use with these units.

11. Corkey 700 Series Unit on Long Backplate

This allows fitting to many types of lock and Corkey unit can be fitted upside down for external use.

12. Corkey 700 Series Unit with Lever Handle Replacing Knob

A double-sided version is also available.

URITY

For clubs, a selected system is pre-programmed for 16 annual code changes. The keys are then re-programmed each year on renewal of membership, thus denying entry to non-subscribers.

Corkey is cost effective in terms of installation and maintenance. As a result of its exceptional benefits it is used in hotels, office buildings, sheltered housing, hospitals, laboratories, educational establishments, all types of residential buildings, factories and warehouses, car parks, sports and social clubs.

Clearly, Corkey has application in all situations where access control and key security really matter.

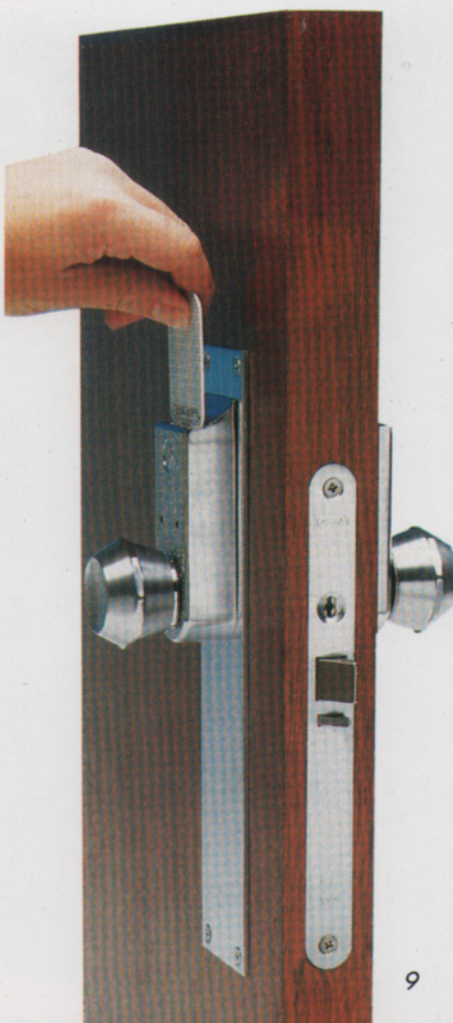

9

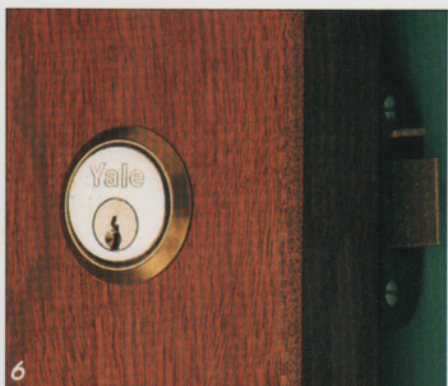

6

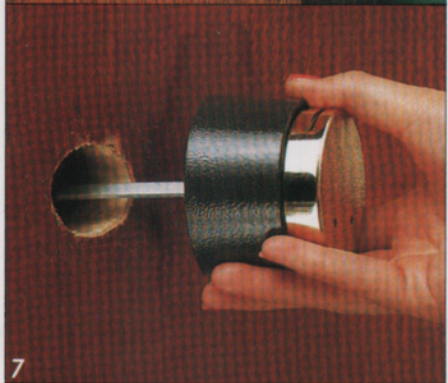

7



8



10

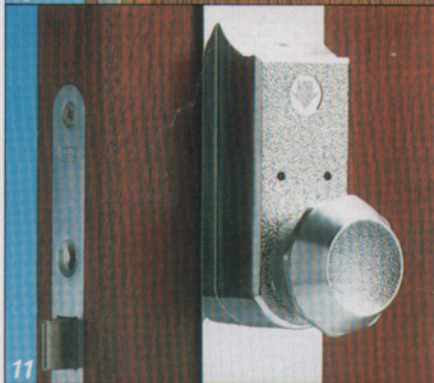

11



12



CORKEY is a unique high quality locking and access control system. It is easy to install and simple to operate, but it is almost impossible to break the coding or duplicate the keys.

Not a conventional lock and key system, it operates by magnetism, replacing the key with either metal or plastic key cards which are codeable. When a key is inserted into a lock and the codes match, the door can be opened; if the codes do not match, the door remains locked.

Corkey adapts to existing locks and it takes only a few seconds to re-code both the key and the lock. There are a possible 4.5 billion different codes which can be entered into a lock. ●



19. Corkeys

Plastic Corkeys can be printed with identification, company logos and numbering.

Metal Corkeys can also be numbered.



13

13. Corkey 300SV

Electric switch lock for surface mounting. Fixing is by two bolts from rear.

14. Corkey 300CV

Lockable stainless steel bezel allows surface mounting where bolt fixing is impossible.

15. Corkey 300WV

Heavy duty steel weather resistant housing for post or wall mounting.

16. 300FV

Chrome or polished brass finish plate for flush mounting. Fixing is by two bolts from the rear.

17. Corkey 300SV with Telephone Entry System

The Corkey 300SV can be used in conjunction with telephone entry systems. The illustration shows a typical flush panel.

18. Corkey 301 Switchlock

The 301 switchlock is designed for internal or external use and is weather resistant. The reader is secured to the base by two screws and a security pin which is released by a valid card.

Three variations are available:

301 TM/C -

Momentary Contact Switch

301 TM/C-DEL -

Momentary Contact Switch with Timed Output Circuit

301 TA/C -

On/Off Switch



14

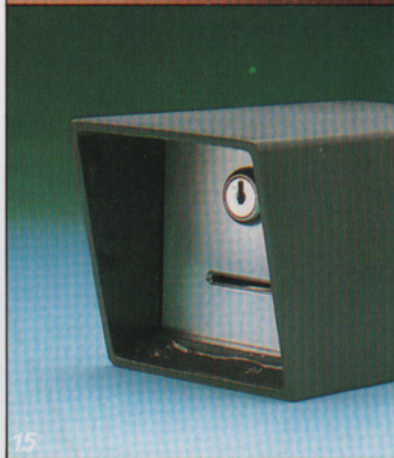

15

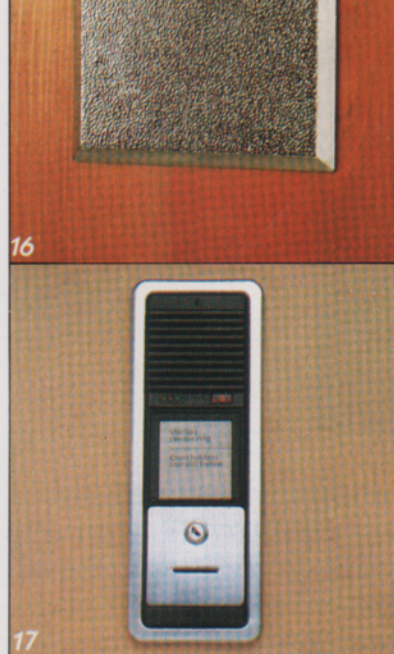

16

17

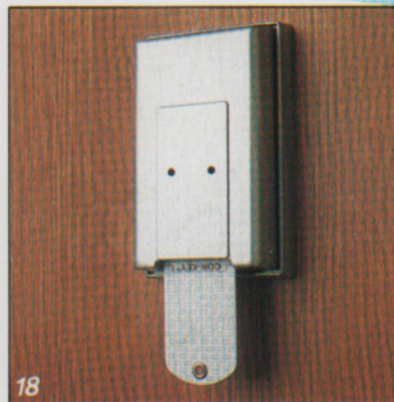

18

ELECTRONIC CORKEY